

**SPECIFIC PLAN AMENDMENT
CITY OF ROSEVILLE, CA**

PC EXHIBIT A

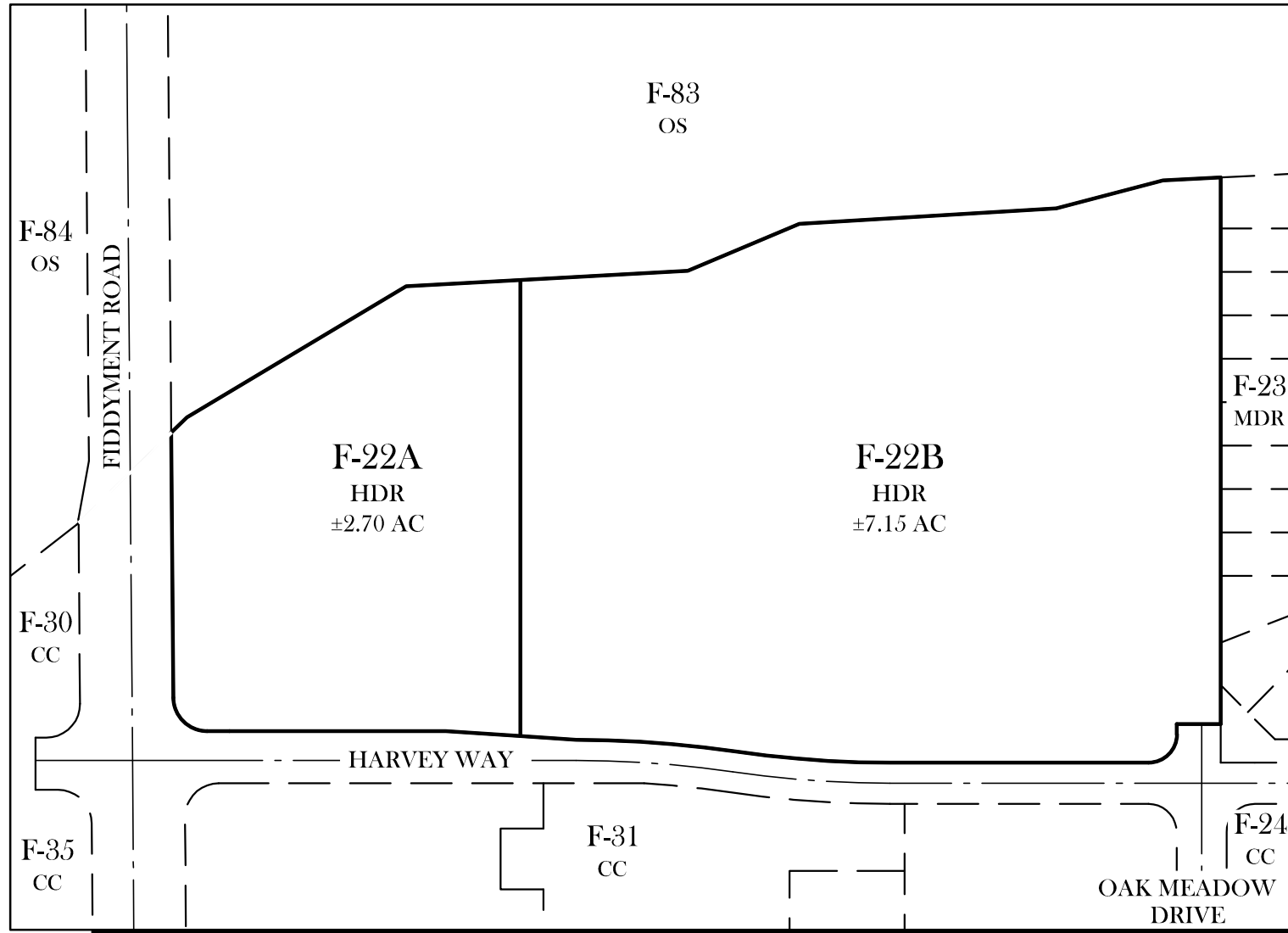

EXISTING

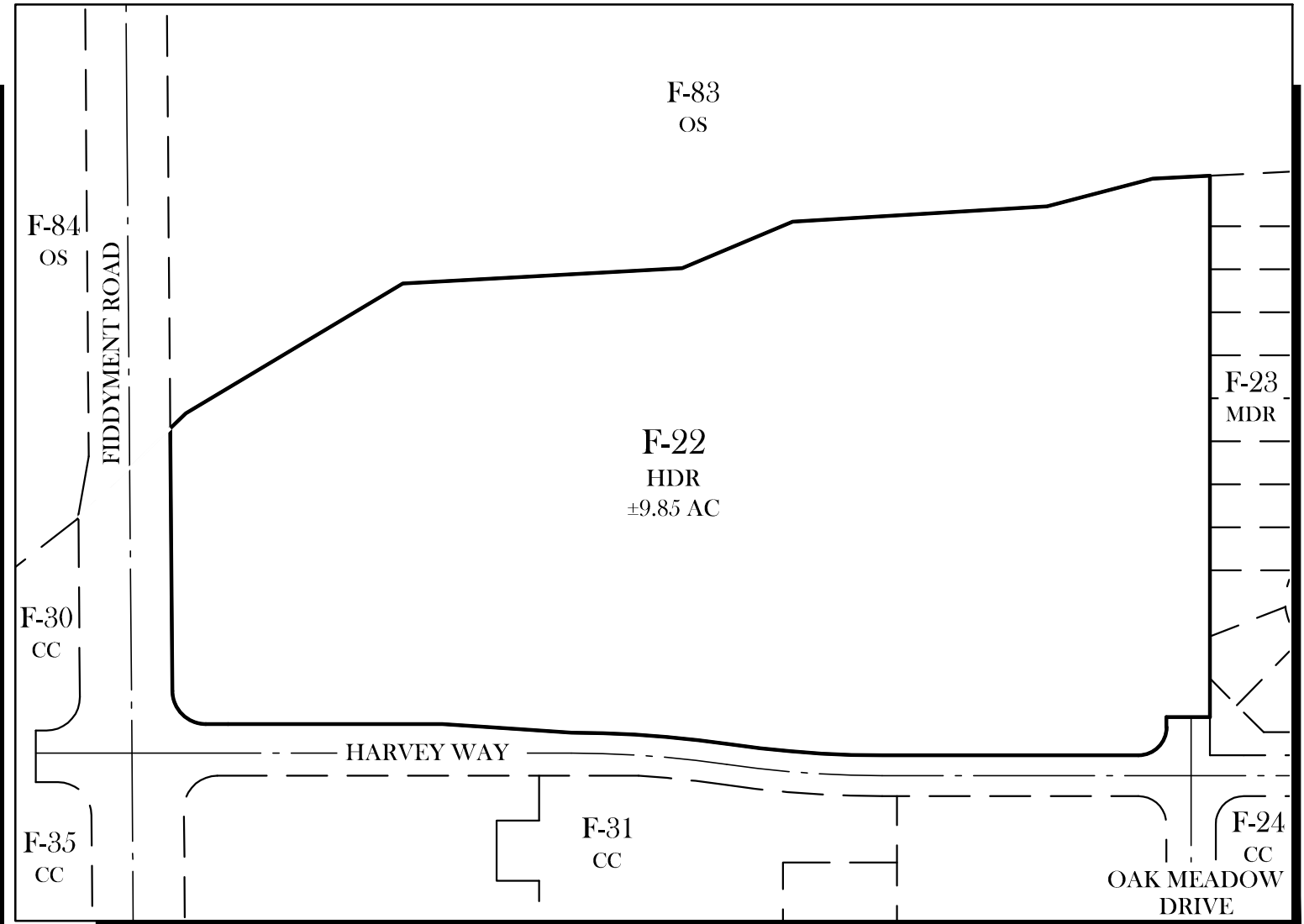

PROPOSED

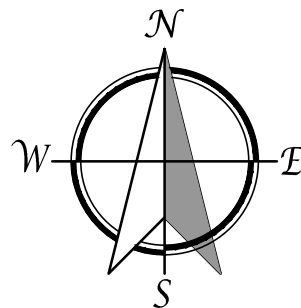

scale: 1"=150'

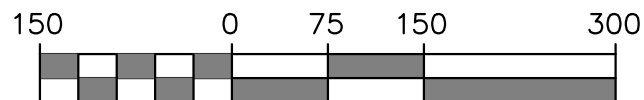

PARCEL NO.	LAND USE	EXISTING ACRES	PROPOSED ACRES
F-22	HIGH DENSITY RESIDENTIAL	0	9.85
F-22A	HIGH DENSITY RESIDENTIAL	2.70	0
F-22B	HIGH DENSITY RESIDENTIAL	7.15	0
TOTALS		9.85	9.85

SPECIFIC PLAN AMENDMENT
AUGUST 8, 2023

TSD ENGINEERING, INC.
expect more.
 785 Orchard Drive, Suite #110
 Folsom, CA 95630
 Phone: (916) 608-0707
 Fax: (916) 608-0701